

music
is what feelings sound like



THE RHYTHM OF LIFE



BUILDERS AND PROMOTORS



BSS Builders and Promoters
NO 44/10, Balegere, Varthur Hobli
Bengaluru, Karnataka, 560087

For Information :
Info@sonestaamelody.com
Web : sonestaamelody.com
Mob : +91 9513444938 / 39

Architect:
FWD
architects
info@fwdarchitects.com
www.fwdarchitects.com



2 & 3 BHK Premium Apartments

Disclaimer: This is only conceptual presentation of project and not a legal offering. The promoters reserve the right to make changes in elevation, plans and specifications as deemed fit.

*Life is one grand sweet song
so start the music.*



True to every sense of the word, Sonestaa Melody is a tribute to the refined tastes and choices you make in life. Just like you don't settle for the ordinary or the run of the mill, at Sonestaa Melody, we go to any extent to make your living worthy of the stature you enjoy. Before everything else, you need a greener planet for a brighter tomorrow. Sonestaa Melody provides you dedicated green zones, all set to harmonize your way of life with nature .



*Music
is the Soundtrack of your life*



WELCOME HOME TO A NEW EXPERIENCE...

At Sonestaa Melody , the design says it all. Optimal utility of the 'square form' makes the project an architectural marvel and a new benchmark of trendy design in Bengaluru. While the concept itself stands leagues apart from convention, special care is taken to strike a new balance between aesthetics and utility.

Unmatched living experience comes as a built-in amenity, you may consider everything else as bonus bounties.





music
is the
shorthand of
emotion

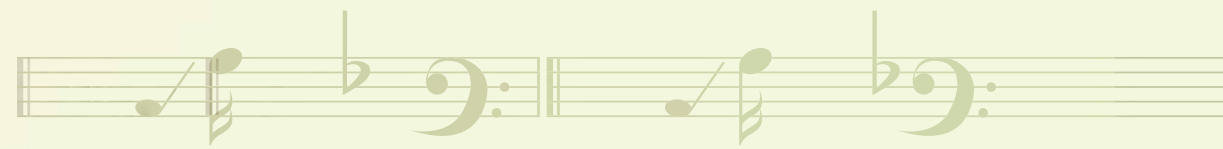

Exclusivity takes on a new dimension at Sonestaa Melody. Welcome to a world of super luxury living that combines the best of modern architectural design with the traditional concept of Vaastu to create unique and personalized living spaces.

Sonestaa Melody boasts of trendy, up-to-the-minute designs, ultra-modern amenities, clean neighborhood and a meticulously chosen location that connects you to everything, anywhere.



- 01 - Entry
- 02 - Exit
- 03 - Security Post
- 04 - Greenary
- 05 - Kids Play Area
- 06 - Swimming Pool
- 07 - Toddlers' Pool
- 08 - Elders Zone
- 09 - Cricket Practice Pitch
- 10 - Badminton Court
- 11 - Drive Way
- 12 - Organic Converter
- 13 - Seating Area
- 14 - Lift
- 15 - Staircase

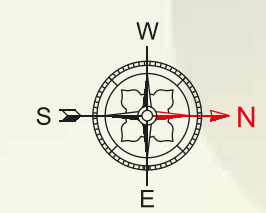

BLOCK A



BLOCK B

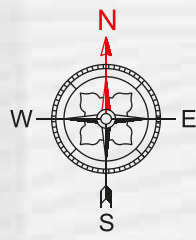
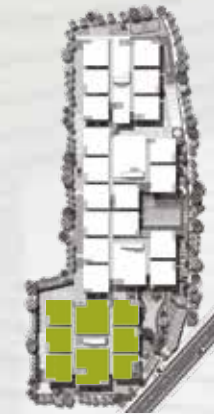
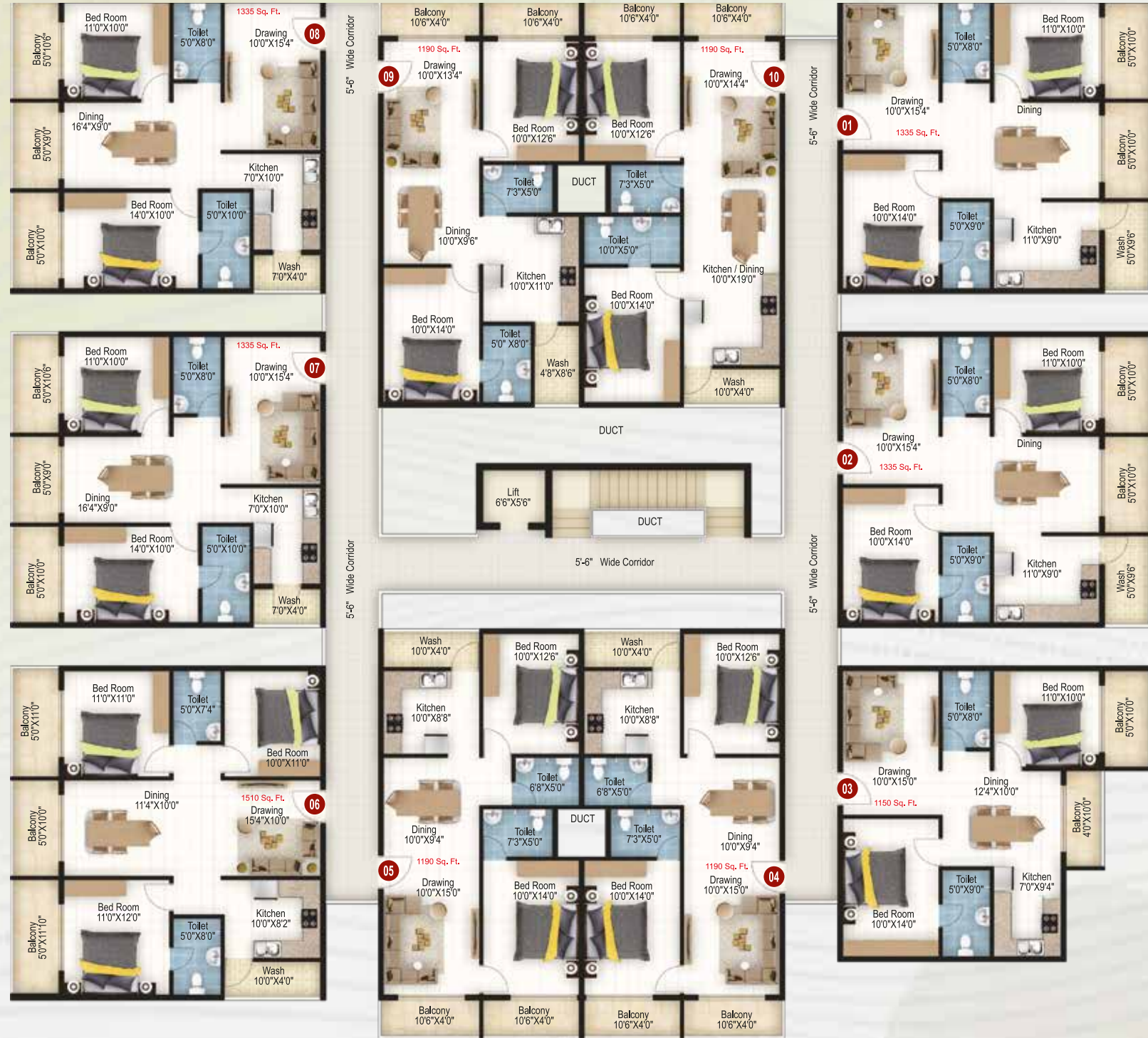

Flat No	Type	SBA (Sft)
01	2BHK	1252
02	2BHK	1252
03	2BHK	1081
04	2BHK	1118
05	2BHK	1118
06	3BHK	1416
07	2BHK	1252
08	2BHK	1252
09	2BHK	1118
10	2BHK	1118



Flat No	Type	SBA
11	3BHK	1416
12	2BHK	1252
13	2BHK	1118
14	2BHK	1118
15	3BHK	1416
16	2BHK	1252
17	2BHK	1252
18	2BHK	1252

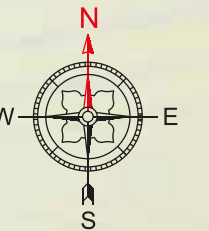
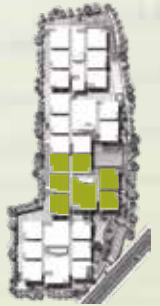

BLOCK C

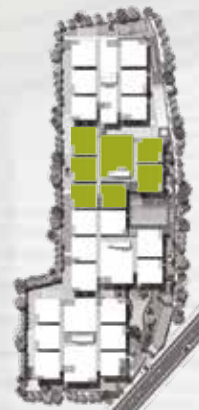

Flat No	Type	SBA
19	2BHK	1252
20	3BHK	1416
21	2BHK	1252
22	2BHK	1252
23	2BHK	1252
24	3BHK	1416
25	2BHK	1118
26	2BHK	1118

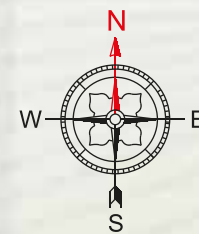

BLOCK D

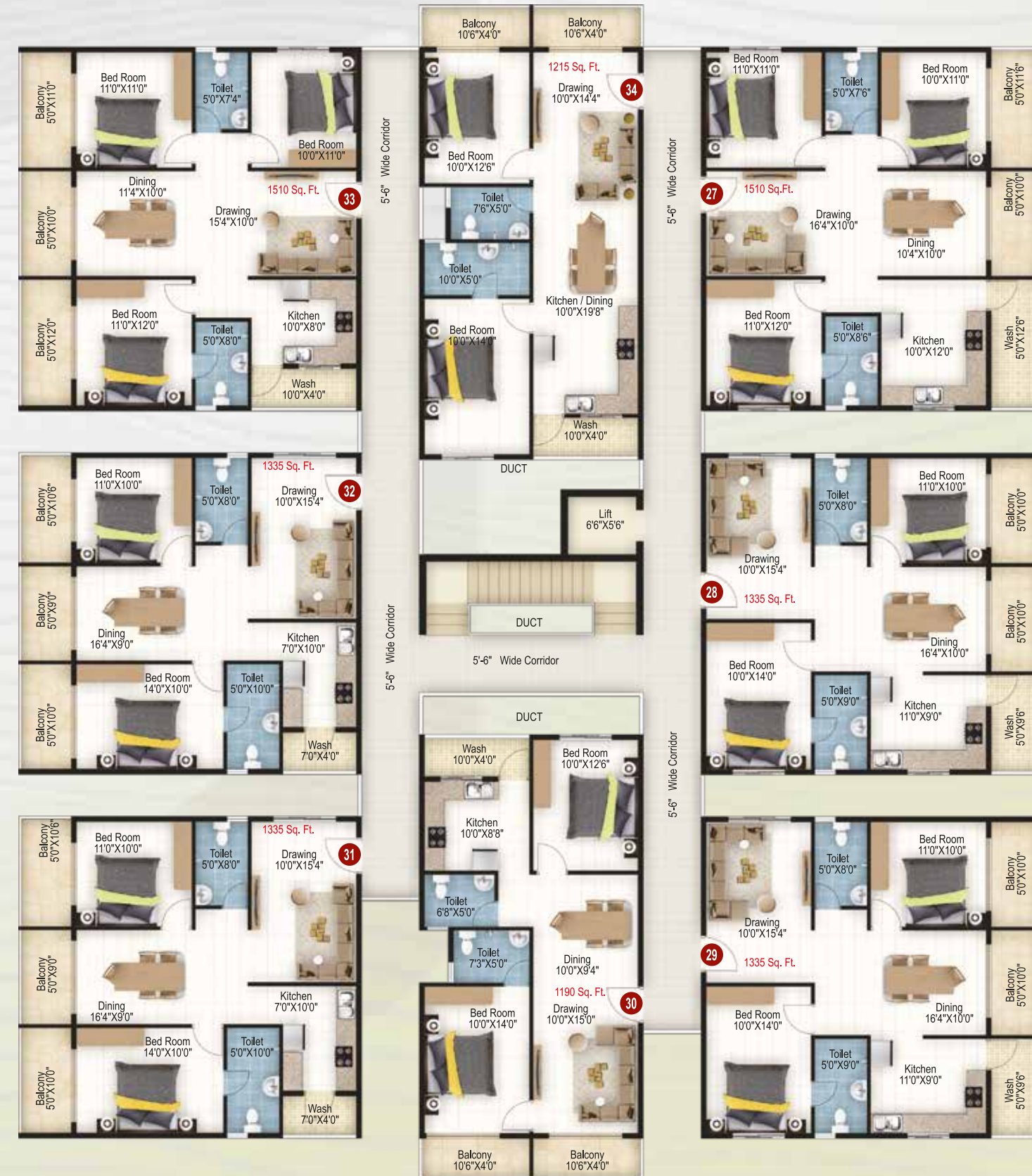

Flat No	Type	SBA
01	3BHK	1416
02	2BHK	1252
03	2BHK	1252
04	2BHK	1118
05	2BHK	1252
06	2BHK	1252
07	3BHK	1416
08	2BHK	1140

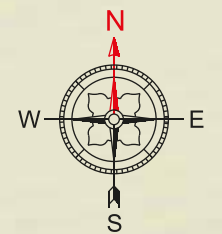

2 BHK

3 BHK



*music
is the shorthand of
emotion*



Swimming Pool

Indoor Gym

Billiards / Snooker

Basketball Post

Badminton Court

Jogging Track

Cricket practice pitch

Club House

Party Hall

Table Tennis etc.

Sewage Treatment Plant

Fire Protection System

Water Treatment Plant

Generator Backup & 24 Hr Security

Organic Water Converter









*Music
lifts up* **moods**











Music
expresses feelings
and thoughts



-  **Structure:** RCC framed Structure
-  **Walls:** 6" thick Cement concrete blocks for exterior walls & 4" thick Cement concrete blocks for interior walls
-  **Kitchen Platform:** Granite platform with Steel sink, 2' height ceramic tiled dado above the cooking platform.
-  **Doors:** All Doors Quality wood frame with Moulded panel shutter.
-  **Lift:** Branded 6 passenger automatic Lift(4 Nos.) .
-  **Car Parking:** Covered car parking.
-  **Flooring:** Vitrified tiles for entire flat & Ceramic tiled flooring for utility.



-  **Toilet:** Anti-skid Ceramic tiled flooring & glaze tile dado upto door height.
-  **Painting:** Asian / Berger or Equivalent Emulsion paint for interiors, Exterior with appex.
-  **Water Supply:** 24hours Water supply.
-  **Sanitary:** Good Quality branded CP fittings & sanitary
-  **Power Backup:** Generator backup for Common area and each flat.
-  **Electrical Work:** Concealed copper wiring with good quality switches.AC point for Master bedroom, Aquaguard & washing machine points.
-  **T.V. & Telephone:** T.V. & Telephone point in Living & Master bedroom.
-  **Windows:** Windows with safety grills.